

# Longreach LX Brochure 2026



it's about the

*Experience*

[Watch  
video  
HERE](#)





# ADVENTURE READY, ULTIMATE COMFORT



Gas Free  
48 Volt Electrical

## Longreach Key Highlights:

- ✓ External entertainment unit with radio, speakers, table, 12v & 240v power & smart TV
- ✓ Gas free model
- ✓ GPS vehicle tracker - RV secure / LOD (Location on demand)
- ✓ Awning roll out x 2 with LED light
- ✓ Awning - slide out awning x 2
- ✓ Cooktop - induction with 2 positions
- ✓ Air Conditioner - Roof mounted x 2
- ✓ Fresh water - 375 ltr
- ✓ Fridge / Freezer - 270ltr Compressor
- ✓ Dishwasher
- ✓ Alarm system - RVsecure/ Platinum X
- ✓ Microwave - multi functional with airfryer, convection oven and grilling
- ✓ Next generation Avida 48V Electrical system
- ✓ Smart TV X 3 (Living, bedroom and external)
- ✓ Starlink ready connections
- ✓ Dual reverse cameras
- ✓ Washing machine and dryer combination
- ✓ Vacuum Cleaner - Dyson
- ✓ Radio External - Blue tooth all in one audio
- ✓ Radio Internal - Chassis & bluetooth all in one audio

E-Model - gas free / 48 volt electrical

### **E-MODELS - ADVANCE GAS-FREE INNOVATION**

The most advanced expression of Avida's E-Model range, these models are fully gas-free and equipped with a powerful 48-volt electrical system. This smart technology delivers efficient energy management, enhanced off-grid capability and a quieter, more sustainable travel experience.

Designed for those who want to stay longer, travel further and reduce their environmental footprint, E-Models with 48-volt electrical systems combine cutting-edge innovation with Avida's trusted quality and nationwide support.





# AVIDA LONGREACH LX

## C9856 2SL

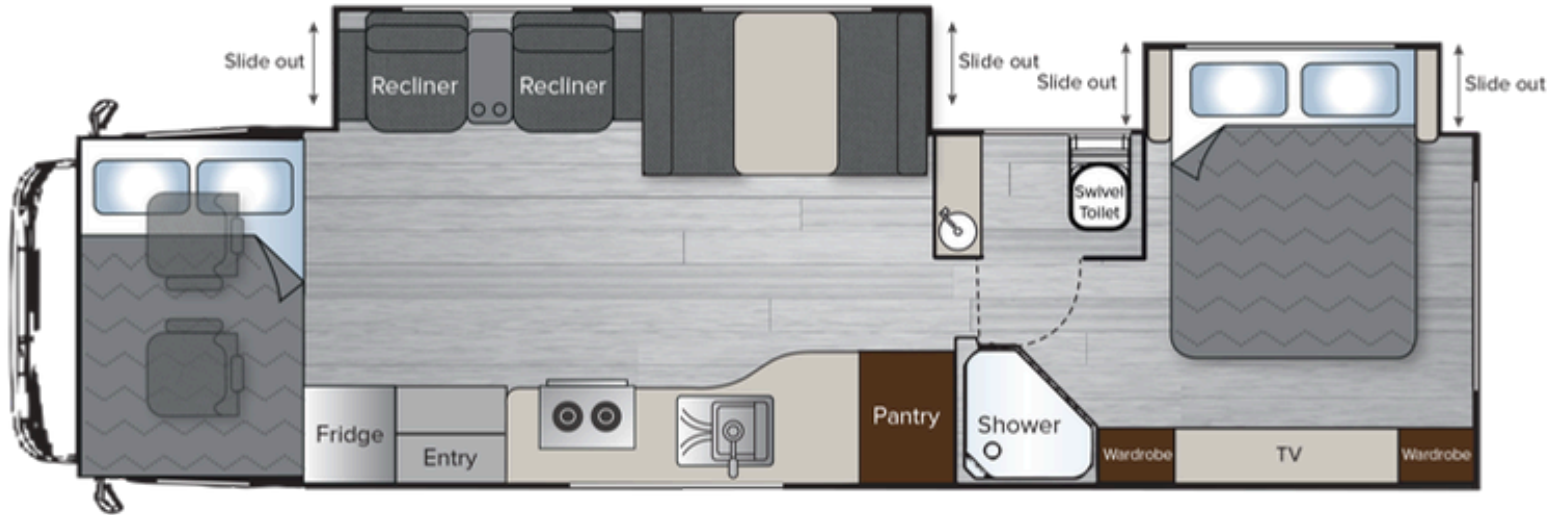

### CHASSIS



Chassis Type	Isuzu NQR 87-190
Drive Type	Dual rear wheel drive
Engine	4-cylinder, turbo
Engine Displacement	5193cc
Output Power	140kw @ 2600rpm
Torque	513Nm @ 1600-2600rpm
Transmission	Automated manual (AMT)
Chassis Voltage	12 volt
Fuel Type	Diesel
Air Conditioning	Automatic climate control
Electric Windows	Driver & passenger
Wheelbase	5425mm
GVM	8800kg

### SPECIFICATIONS



Exterior Length	9850mm
Exterior Height	3640mm
Exterior Width	2490mm
Interior Height	1980mm
Fresh Water	375ltr
Grey Water	250ltr
Licence	Medium rigid
Towing Capacity	3500kg
Fuel Capacity	140ltr
Sleeps	2 - 6
Seat Belts	4 - 6



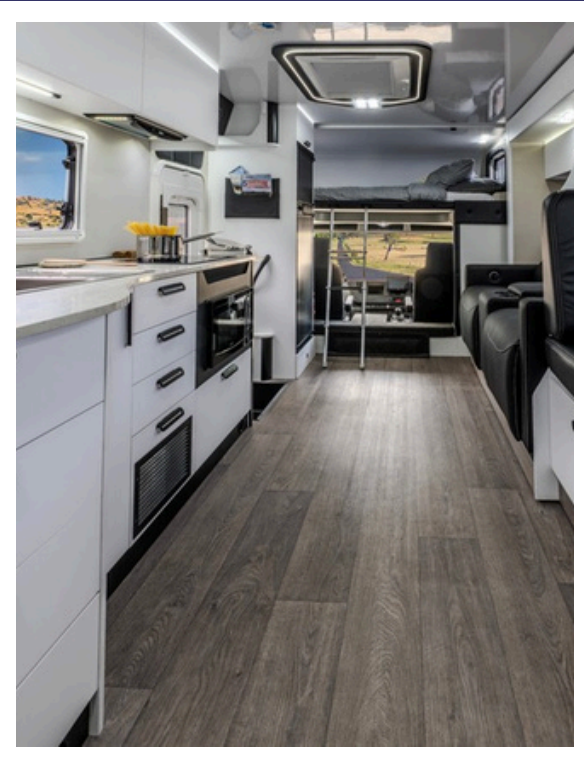



# CELEBRATING 60 YEARS OF INNOVATION



Avida, the longest-serving motorhome RV manufacturer in Australia still in the hands of the original owners, has been a leader in the RV industry since 1965, known for our high-quality, **Australian-made** motorhomes, campervans, and caravans. From our humble beginnings, Avida has built a legacy of innovation, customer dedication, and family values. We manufacture our RVs entirely in Australia, employing local talent at our Emu Plains facility west of Sydney, setting a standard for durability, performance, and comfort that has inspired travellers for more than **six decades**.

**OUR VISION:** To create the vehicle that fulfils our customer's dream lifestyle.



## AVIDA 60 Years of Australian Made Innovation

Celebrating six decades of Australian manufacturing, here's a glance at our Journey. From our humble beginnings to our most recent milestones, this timeline is a snapshot of some key events that have defined Avida's legacy.

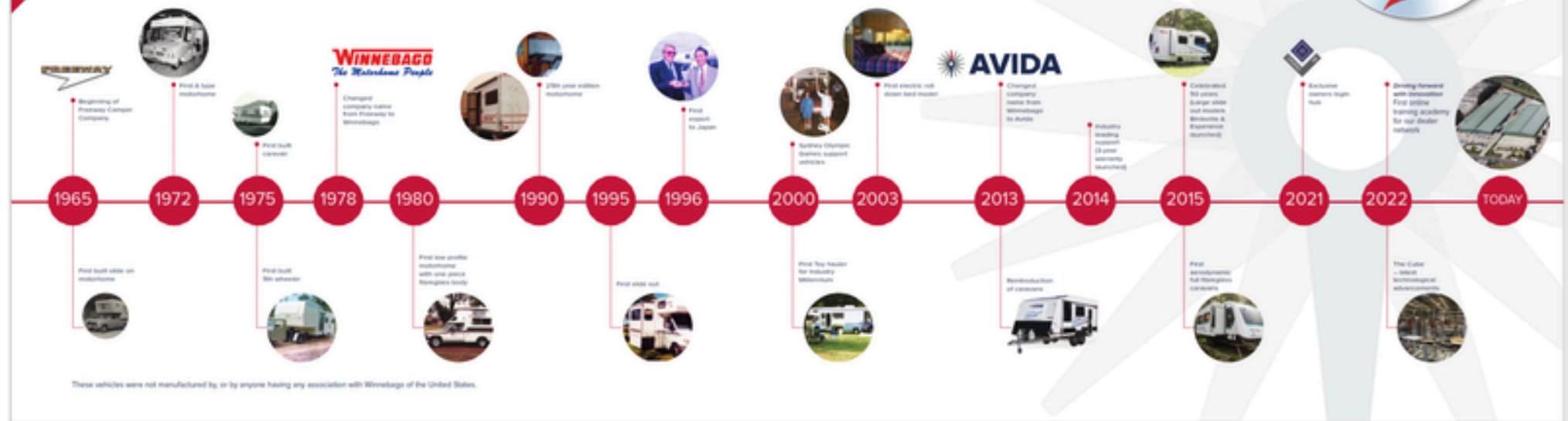

it's about the  
*Experience*





# PEACE OF MIND

Every Avida comes backed by Avida's renowned peace of mind support, offering unmatched coverage to keep you travelling with confidence. With comprehensive warranties, roadside assistance, and a national service network, Avida ensures that wherever your adventure takes you, help is just a call away.

*For a limited time*



**STRUCTURAL WARRANTY**



**FACTORY WARRANTY\***

60-month offers  
to celebrate  
Avida's 60th  
anniversary



**CHASSIS WARRANTY**



**ROADSIDE ASSISTANCE**



**CAPPED PRICE SERVICING**

\*Conditions apply, refer to Avida website



# WHAT OUR CUSTOMERS HAVE TO SAY

**'Excellent service from Avida, always there to help with any enquiries.'**

*- Leonie, Lake Munmorah NSW*

'From the moment we walked into the dealership, our sales person was professional, knowledgeable, and his friendly demeanour stood out. His willingness to patiently answer all our questions and guide us through the entire process made our experience truly memorable. Not only were we helped to find us the perfect motorhome to suit our needs, but he also went above and beyond to ensure that the entire purchasing journey was smooth and stress-free. His attention to detail and dedication to customer satisfaction are truly commendable.'

*- Carmen, Yarrawonga Vic*

**'Quality and finish of the product are excellent.  
The hand over from the dealership was thorough.'**

*- Gerard, Ferntree Gully Vic*

'We used the experience hub to follow production of our vehicle. It provided the factory specs even though we had not been asked for our choice. Knew our vehicle was in quality control prior to dealer advice.'

*- David and Carolyn, Shell Cove NSW*

**'At this stage the Motorhome looks great and the dealer has been excellent.'**

*- Peter, Raworth NSW*





## FACTORY TOUR

Visit our modern manufacturing facility at Emu Plains, west of Sydney where you can enjoy a guided factory tour held on Fridays by APPOINTMENT ONLY.

Please note, tour numbers are limited.

Book via the Avida website.



## INDUSTRY ACCREDITED

RVMAP, Australia's Caravan Industry accreditation program requires all RVs produced by members to comply fully with all safety regulations, including Australian Design Rules and Australian Standards.



## VIRTUAL SHOWROOM

Experience the future of product exploration with Avida's Virtual Showroom. Designed for convenience and accessibility, our immersive digital platform lets you browse our latest range anytime, from anywhere. With 360-degree views, interactive features, and detailed product insights, you can get up close and personal with each model without leaving your home. Explore both the interior and exterior of every design to find the perfect fit for your needs.

Discover innovation at your fingertips with Avida's Virtual Showroom today!



## DEALERS

- Factory trained Dealer Network
- Over 100 accredited service locations
- Australia and New Zealand



## WARRANTY

\*Limited time offers

- 60 - months factory backed warranty
- 60 - months structural guarantee
- 60 - months chassis warranty



## SUPPORT

\*Limited time offers

- 60 - months roadside assistance
- 60 - months capped price servicing

it's about the

*Experience*

